

Пластины для фрез CoroMill® 216F со сферическим концом

Чистовая обработка

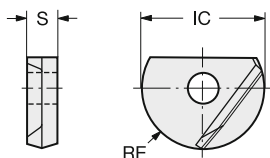

Метрическое исполнение

Легкая	RE	Код заказа	Размеры, мм, дюйм						
			P	M	K	S	H		
			IC	S					
	08 4.0	R216F-08 24 E-L	☆	☆	☆	☆	☆	8.0	2.40
	.157							.315	.094
	10 5.0	R216F-10 26 E-L	☆	☆	☆	☆	☆	10.0	2.60
	.197							.394	.102
	12 6.0	R216F-12 30 E-L	☆	☆	☆	☆	☆	12.0	3.00
	.236							.472	.118
	16 8.0	R216F-16 40 E-L	☆	☆	☆	☆	☆	16.0	4.00
	.315							.630	.157
	20 10.0	R216F-20 50 E-L	☆	☆	☆	☆	☆	20.0	5.00
	.394							.787	.197
25 12.5	R216F-25 60 E-L	☆	☆	☆	☆	☆	25.0	6.00	
.492							.984	.236	
30 15.0	R216F-30 70 E-L	☆	☆	☆	☆	☆	30.0	7.00	
.591							1.181	.276	
32 16.0	R216F-32 70 E-L	☆	☆	☆	☆	☆	32.0	7.00	
.630							1.260	.276	

Дюймовое исполнение

Легкая	RE	Код заказа	Размеры, мм, дюйм						
			P	M	K	S	H		
			IC	S					
	5/16 4.0	RA216F-08 24 E-L	☆	☆	☆	☆	☆	7.9	2.40
	.156							.313	.094
	3/8 4.8	RA216F-10 26 E-L	☆	☆	☆	☆	☆	9.5	2.54
	.187							.375	.100
	1/2 6.4	RA216F-13 30 E-L	☆	☆	☆	☆	☆	12.7	3.00
	.250							.500	.118
	5/8 7.9	RA216F-16 40 E-L	☆	☆	☆	☆	☆	15.9	4.00
	.313							.625	.157
	3/4 9.5	RA216F-19 50 E-L	☆	☆	☆	☆	☆	19.1	5.00
	.375							.750	.197
1 12.7	RA216F-25 60 E-L	☆	☆	☆	☆	☆	25.4	6.00	
.500							1.000	.236	
1 1/4 15.9	RA216F-32 70 E-L	☆	☆	☆	☆	☆	31.8	7.00	
.625							1.250	.276	

Допуски:

ICTOLL	ICTOLU	ICTOLL"	ICTOLU"
-0.016	0	-.00063	0



J474



J508



Q1



Q17

Фрезы CoroMill® 216F со сферическим концом

Метрическое исполнение

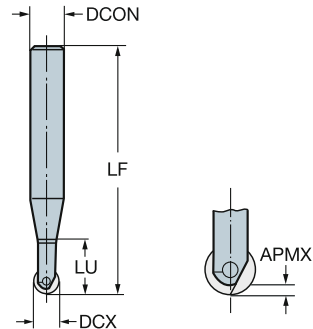
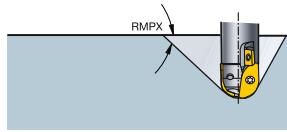

Стальной хвостовик

							Размеры, мм									
DC		CZC _{MS}	APMX	RMPX	CNSC		Код заказа	DCON	DCX	LF	LU			RPMX	CICT _{BALL}	MIID _{BALL}
8.0	08	12	1.2	85°	0	2	R216F-08A12S-053	12.0	8.0	110.0	41.5	0.9	0.20	33600	1	R216F-08..
	08	12	1.2	85°	0	2	R216F-08A12S-075	12.0	8.0	132.0	41.8	0.9	0.20	16800	1	R216F-08..
	08	12	1.2	85°	0	2	R216F-08A12S-035	12.0	8.0	92.0	23.1	0.9	0.20	40000	1	R216F-08..
10.0	10	12	1.5	85°	0	2	R216F-10A12S-053	12.0	10.0	110.0	51.9	1.2	0.17	40000	1	R216F-10..
	10	12	1.5	85°	0	2	R216F-10A12S-075	12.0	10.0	132.0	73.6	1.2	0.20	20300	1	R216F-10..
	10	12	1.5	85°	0	2	R216F-10A12S-038	12.0	10.0	95.0	30.0	1.2	0.17	40000	1	R216F-10..
12.0	12	12	1.8	85°	0	2	R216F-12A12S-053	12.0	12.0	110.0	53.0	1.2	0.20	40000	1	R216F-12..
	12	12	1.8	85°	0	2	R216F-12A12S-026	12.0	12.0	83.0	26.0	1.2	0.18	40000	1	R216F-12..
	12	16	1.8	85°	0	2	R216F-12A16S-085	16.0	12.0	145.0	63.3	1.2	0.29	19800	1	R216F-12..
16.0	16	16	2.4	85°	0	2	R216F-16A16S-063	16.0	16.0	123.0	63.0	3.0	0.31	36000	1	R216F-16..
	16	16	2.4	85°	0	2	R216F-16A16S-032	16.0	16.0	92.0	32.0	3.0	0.26	36000	1	R216F-16..
	16	20	2.4	85°	0	2	R216F-16A20S-100	20.0	16.0	166.0	75.5	3.0	0.44	20000	1	R216F-16..
20.0	20	20	3.0	85°	0	2	R216F-20A20S-038	20.0	20.0	104.0	38.0	5.0	0.38	40000	1	R216F-20..
	20	20	3.0	85°	0	2	R216F-20A20S-075	20.0	20.0	141.0	75.0	5.0	0.44	40000	1	R216F-20..
	20	25	3.0	85°	0	2	R216F-20A25S-115	25.0	20.0	191.0	82.2	5.0	0.68	18400	1	R216F-20..
25.0	25	25	3.8	85°	0	2	R216F-25A25S-045	25.0	25.0	121.0	25.0	5.0	0.54	40000	1	R216F-25..
	25	25	3.8	85°	0	2	R216F-25A25S-090	25.0	25.0	166.0	90.0	5.0	0.70	37100	1	R216F-25..
	25	32	3.8	85°	0	2	R216F-25A32S-135	32.0	25.0	215.0	97.0	5.0	1.17	16500	1	R216F-25..
32.0	30	32	4.8	85°	0	2	R216F-32A32S-054	32.0	32.0	134.0	54.0	26.0	0.85	35500	1	R216F-30/32..
	30	32	4.8	85°	0	2	R216F-32A32S-107	32.0	32.0	187.0	107.0	26.0	1.86	32500	1	R216F-30/32..
	30	32	4.8	85°	0	2	R216F-32A32S-160	32.0	32.0	240.0	160.0	26.0	1.56	14500	1	R216F-30/32..

Твердоспл. хвостовик

							Размеры, мм									
DC		CZC _{MS}	APMX	RMPX	CNSC		Код заказа	DCON	DCX	LF	LU			RPMX	CICT _{BALL}	MIID _{BALL}
8.0	08	12	1.2	85°	0	2	R216F-08A12C-035	12.0	8.0	92.0	24.0	0.9	0.22	40000	1	R216F-08..
	08	12	1.2	85°	0	2	R216F-08A12C-053	12.0	8.0	110.0	30.0	0.9	0.24	40000	1	R216F-08..
	08	12	1.2	85°	0	2	R216F-08A12C-075	12.0	8.0	132.0	37.0	0.9	0.26	23400	1	R216F-08..
10.0	10	12	1.5	85°	0	2	R216F-10A12C-053	12.0	10.0	110.0	41.4	1.2	0.24	40000	1	R216F-10..
	10	12	1.5	85°	0	2	R216F-10A12C-075	12.0	10.0	132.0	51.0	1.2	0.26	23400	1	R216F-10..
12.0	12	12	1.8	85°	0	2	R216F-12A12C-053	12.0	12.0	110.0	53.0	2.0	0.26	40000	1	R216F-12..
	12	16	1.8	85°	0	2	R216F-12A16C-085	16.0	12.0	145.0	65.6	2.0	0.38	21000	1	R216F-12..
16.0	16	16	2.4	85°	0	2	R216F-16A16C-063	16.0	16.0	123.0	63.0	3.0	0.44	43000	1	R216F-16..
	16	20	2.4	85°	0	2	R216F-16A20C-100	20.0	16.0	166.0	87.0	3.0	0.66	25500	1	R216F-16..
20.0	20	25	3.0	85°	0	2	R216F-20A25C-115	25.0	20.0	191.0	75.6	5.0	1.17	18500	1	R216F-20..



J240



O5



Q1



Q35



Q16

Фрезы CoroMill® 216F со сферическим концом

Дюймовое исполнение

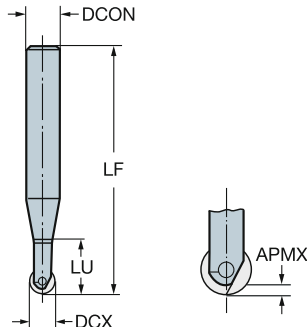
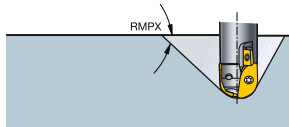

Стальной хвостовик

DC		CZC _{MIS}	APMX	RMPX	CNSC	Код заказа	Размеры, дюйм						CIC _{TBALL}	MID _{BALL}		
DC	DC						DCON	DCX	LF	LU	Nm	Kg	RPMX			
.313	5/16	1/2	.047	85°	0	2	RA216F-08013S-035	.500	.313	3.622	.906	.6	0.9	40000	1	RA216F-08..
	5/16	1/2	.047	85°	0	2	RA216F-08013S-053	.500	.313	4.331	1.618	.6	0.9	33100	1	RA216F-08..
	5/16	1/2	.047	85°	0	2	RA216F-08013S-075	.500	.313	5.197	1.610	.6	0.9	16500	1	RA216F-08..
.375	3/8	1/2	.055	85°	0	2	RA216F-10013S-038	.500	.375	3.732	1.102	.8	0.9	40000	1	RA216F-10..
	3/8	1/2	.055	85°	0	2	RA216F-10013S-053	.500	.375	4.323	1.937	.8	0.9	40000	1	RA216F-10..
	3/8	1/2	.055	85°	0	2	RA216F-10013S-075	.500	.375	5.189	2.417	.8	0.9	20400	1	RA216F-10..
.500	1/2	1/2	.075	85°	0	2	RA216F-13013S-026	.500	.500	3.282	1.047	1.4	0.9	40000	1	RA216F-13..
	1/2	1/2	.075	85°	0	2	RA216F-13013S-053	.500	.500	4.344	2.110	1.4	0.9	40000	1	RA216F-13..
	1/2	5/8	.075	85°	0	2	RA216F-13016S-085	.625	.500	5.722	3.102	1.4	1.7	19800	1	RA216F-13..
.625	5/8	5/8	.091	85°	0	2	RA216F-16016S-032	.625	.625	3.620	1.257	2.2	1.7	36000	1	RA216F-16..
	5/8	5/8	.091	85°	0	2	RA216F-16016S-063	.625	.625	4.840	2.478	2.2	1.7	36000	1	RA216F-16..
	5/8	3/4	.091	85°	0	2	RA216F-16019S-100	.750	.625	6.533	2.850	2.2	2.0	20000	1	RA216F-16..
.750	3/4	3/4	.110	85°	0	2	RA216F-19019S-038	.750	.750	4.076	1.477	3.6	2.0	40000	1	RA216F-19..
	3/4	3/4	.110	85°	0	2	RA216F-19019S-075	.750	.750	5.532	2.934	3.6	2.0	40000	1	RA216F-19..
	3/4	1	.110	85°	0	2	RA216F-19025S-115	1.000	.750	7.500	2.602	3.6	3.1	18400	1	RA216F-19..
1.000	1	1	.150	85°	0	2	RA216F-25025S-045	1.000	1.000	4.772	1.780	5.5	2.5	40000	1	RA216F-25..
	1	1	.150	85°	0	2	RA216F-25025S-090	1.000	1.000	6.543	3.551	5.5	3.1	37100	1	RA216F-25..
	1	1 1/4	.150	85°	0	2	RA216F-25032S-135	1.250	1.000	8.472	4.047	5.5	5.7	16500	1	RA216F-25..
1.250	1 1/4	1 1/4	.185	85°	0	2	RA216F-32032S-054	1.250	1.250	5.271	2.121	19.1	4.0	35500	1	RA216F-32..
	1 1/4	1 1/4	.185	85°	0	2	RA216F-32032S-107	1.250	1.250	7.357	4.208	19.1	5.7	32500	1	RA216F-32..
	1 1/4	1 1/4	.185	85°	0	2	RA216F-32032S-160	1.250	1.250	9.444	6.294	19.1	8.1	14500	1	RA216F-32..

Твердоспл. хвостовик

DC		CZC _{MIS}	APMX	RMPX	CNSC	Код заказа	Размеры, дюйм						CIC _{TBALL}	MID _{BALL}		
DC	DC						DCON	DCX	LF	LU	Nm	Kg	RPMX			
.313	5/16	1/2	.047	85°	0	2	RA216F-08013C-075	.500	.313	5.196	1.429	.6	0.9	40000	1	RA216F-08..
.375	3/8	1/2	.055	85°	0	2	RA216F-10013C-075	.500	.375	5.187	1.736	.8	0.9	40000	1	RA216F-10..
.500	1/2	5/8	.075	85°	0	2	RA216F-13016C-085	.625	.500	5.722	3.189	1.4	1.7	40000	1	RA216F-13..
.625	5/8	3/4	.091	85°	0	2	RA216F-16019C-100	.750	.625	6.532	3.425	2.2	0.4	24000	1	RA216F-16..
.750	3/4	1	.110	85°	0	2	RA216F-19025C-115	1.000	.750	7.501	2.460	3.6	5.7	40000	1	RA216F-19..

